

DESCRIPTION OF CALIPER COMPONENTS

- | | |
|---|--|
| 1. Measuring caliper | 7. Interchangeable MD measurement keys |
| 2. Support for caliper | 8. Measurement key retaining nut |
| 3. Movable spindle | 9. Interchangeable support table |
| 4. Lifting levers movable button | 10. Adjustment and locking key for table support spindle |
| 5. Capacity adjustment spindle | 11. Bore $\varnothing 8H7$ for dial indicator |
| 6. Adjusting and locking keys for adjusting spindle | 12. Knurled key for fixing caliper to support |

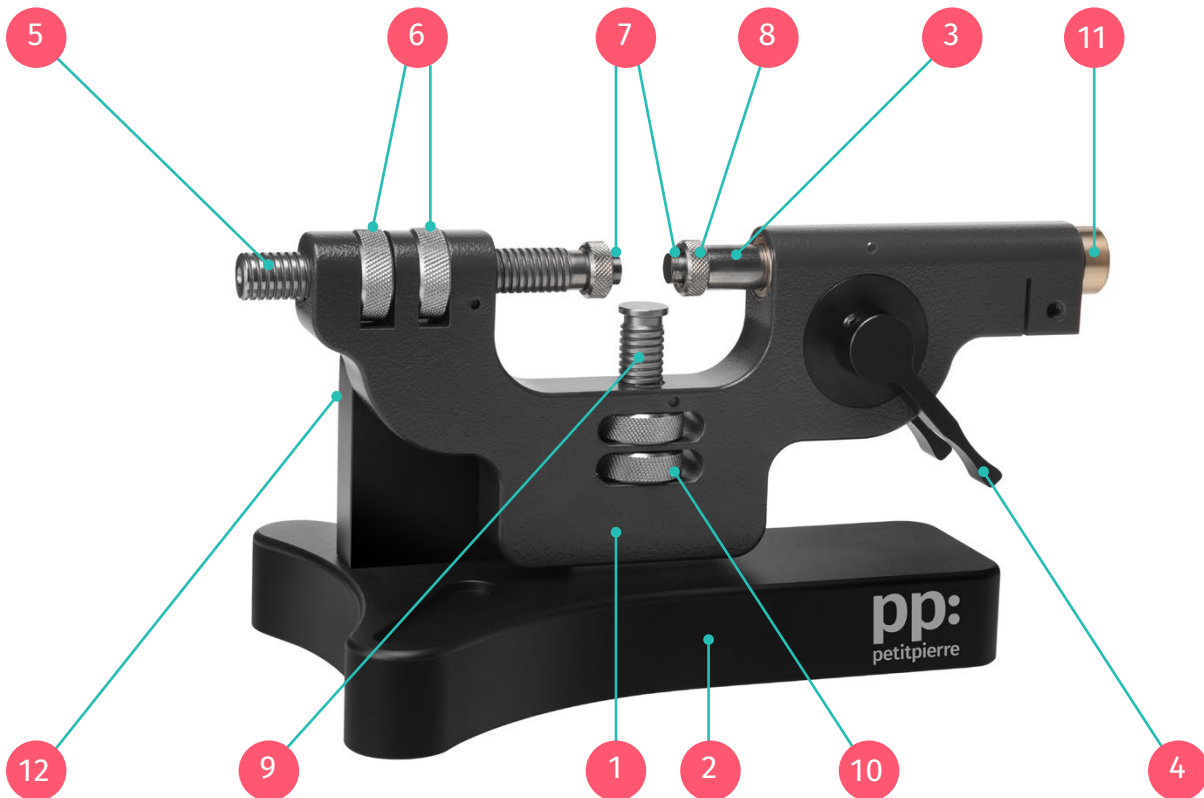

DESIGNATION	DETAIL	ITEM CODE	UNIT PRICE IN CHF
<p>Measuring caliper - Starter Kit</p> <p>Includes :</p> <ul style="list-style-type: none"> • Measuring caliper • Support for measuring caliper • Support table STD $\varnothing 10 \times 1.5$ mm • Measuring keys STD (2x) $\varnothing 6 \times 4.0$ mm • SYLVAC digital comparator • Storage case 		40-0011-060	2'350.00
<p>Measuring caliper - Basic Kit</p> <p>Includes :</p> <ul style="list-style-type: none"> • Measuring caliper • Support for measuring caliper • Support table STD $\varnothing 10 \times 1.5$ mm • Measuring keys STD (2x) $\varnothing 6 \times 4.0$ mm • Storage case 		40-0011-050	1'760.00
<p>Measuring caliper Without stand, without measuring keys, with Support table STD $\varnothing 10 \times 1.5$ mm</p>		40-0011-000	1'335.00
<p>Support for measuring caliper</p>		40-0011-001	235.00
<p>Storage case (400 x 300 x 120 mm) foamed, with storage compartments for measuring caliper and accessories</p>		40-0011-017	48.00

DESIGNATION	DETAIL	ITEM CODE	UNIT PRICE IN CHF
-------------	--------	-----------	-------------------

MD CYLINDRICAL MEASUREMENT KEY

Designation	ϕD	L
$\phi 2.0 \times 4$	2.0	4.0
$\phi 6.0 \times 4$ (standard key)	6.0	4.0
$\phi 8.0 \times 4$	8.0	4.0
$\phi 12.0 \times 5.5$	12.0	5.5

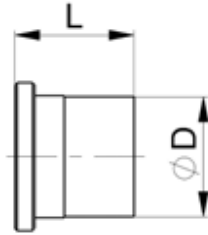

40-0011-005	115.00
40-0011-006	100.00
40-0011-007	145.00
40-0011-008	210.00

Other dimensions on request

MD KNIFE MEASURING KEYS

Designation	B	F	C
0.10 x 1.0 x 4	0.10	1.0	4
0.15 x 1.5 x 4	0.15	1.5	4
0.20 x 2.2 x 4	0.20	2.2	4
0.20 x 2.2 x 4	0.30	2.2	4
0.20 x 2.2 x 4	0.40	2.2	4

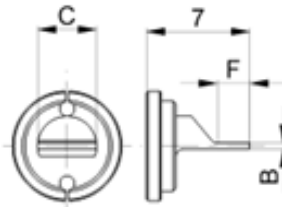

40-0011-019	395.00
40-0011-020	395.00
40-0011-021	395.00
40-0011-022	395.00
40-0011-014	315.00

Other dimensions on request

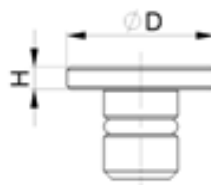

STAINLESS STEEL SUPPORT TABLE

Designation	ϕD	H
$\phi 10 \times 1.5$ (standard bench)	10.0	1.5
$\phi 40 \times 2.0$	40.0	2.0

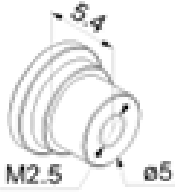

40-0011-002	45.00
40-0011-003	135.00

Other dimensions on request

DESIGNATION	DETAIL	ITEM CODE	UNIT PRICE IN CHF
ADAPTER FOR M2.5 THREADED ROD PROBE		40-0011-015	60.00
MEASUREMENT BUTTON FIXING NUT (AFTER-SALES SUPPLY)		40-0011-004	40.00
SYLVAC DIGITAL COMPARATOR		40-0011-016	585.00
S-Dial Works ADV 0.001 12.5			
Protection	IP54		
Stroke	12.5 mm		
Precision	3 μm		
Repeatability	2 μm		
Display	1 μm		
Measuring force	0.65-0.9 N		

REPLACEMENT OF SUPPORT TABLE

The standard support table ($\varnothing 10 \times 1.5$) supplied with the bracket can be quickly replaced by another size. It is easily removed by axial traction. The new table can then be inserted by simply pressing

MOUNTING THE CALIPER ON ITS SUPPORT

The caliper can be fixed on its support in 3 different indexed positions



Horizontal



Tilted at 45°



Vertical

- Partially insert the pivot into the caliper bore.
- Orient caliper to desired position, then insert bracket indexing pin into caliper bore.
- Turn the knurled key clockwise to secure the caliper to the bracket.

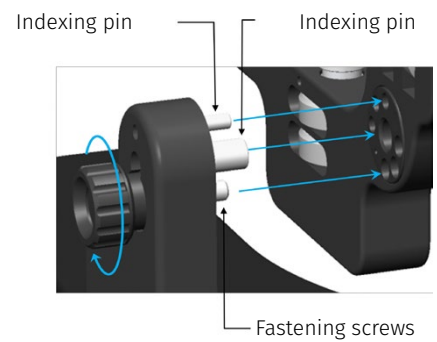

COMPARATOR MOUNTING

The caliper is designed to be fitted with a comparator (feeler) with a $\varnothing 8H7$ range.

The fit of the comparator differs according to the version of the caliper. Here are the 2 mounting methods used.

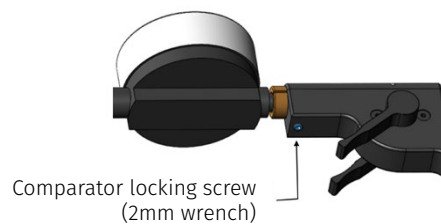
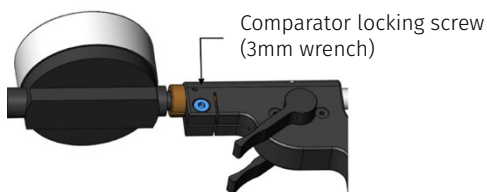

MOUNTING INTERCHANGEABLE MEASURING KEYS

The principle of mounting the measuring keys differs according to their geometry.

Ømax 6 mm cylindrical key mounting & key adapter

- Unscrew knurled retaining nut (e) completely.
- Place measuring key (t) against spindle face (b).
- Insert the nut onto the measuring key.
- Screw on nut as far as it will go.

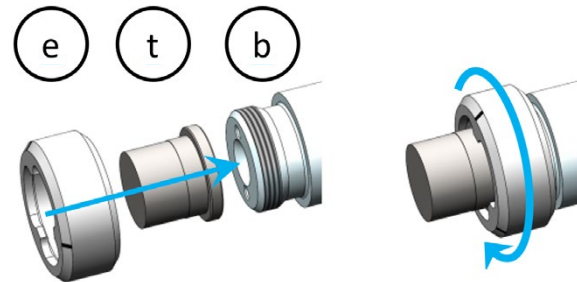

Mounting cylindrical key Ø > 6 mm

- Partially unscrew the retaining nut, positioning one of the lines engraved on its chamfer against the top.
- Insert the measuring key into the nut with one of its flats positioned against the top.
- Turn the key by 60° only, so as to align the lines engraved on the key with those on the nut.
- Simultaneously screw in the key and the nut as far as they will go.

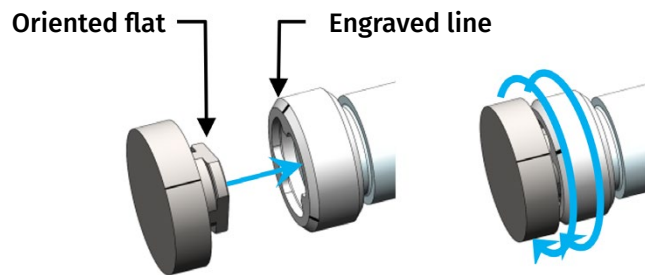

Knife-tip assembly

- Unscrew the retaining nut completely.
- Place the measuring key against the face of the spindle, inserting its 2 lugs into the bores.
- Insert the nut onto the measuring key.
- Screw on the nut as far as it will go.

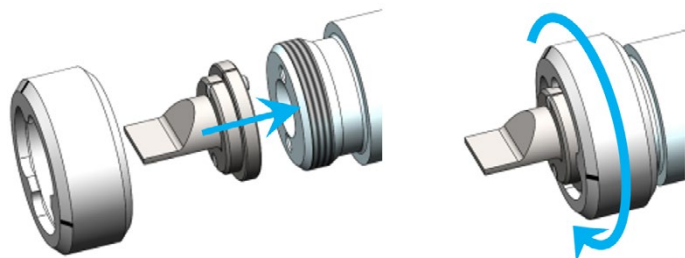

Important: to ensure parallelism of the measuring key, it is essential that the contact surfaces between the measuring key and the spindle are extremely clean!